



SURPASSION RX

www.cougargaming.com

SURPASSION RX

With Surpassion RX, we have done what many thought to be impossible: we have merged a wired gaming mouse's accuracy and reliability with the freedom of a wireless gaming mouse. See and believe!

FEATURES

ENGLISH

- 7200 DPI Optical Gaming Sensor with DPI fine-tuning
- 1000Hz Wireless Technology
- Works Both Wired and Wireless
- 11-Color Backlight with 13 Modes
- LCD Screen with 2 Buttons for DPI, Polling Rate, LOD, and Angle Snapping fine-tuning
- 600mAh Lithium Battery
- Battery Life Up to 20 Hours at 1000 Hz Polling Rate
- Battery Indicator in the LCD Screen
- OMRON switches with 50 million presses
- Ergonomic Shape With Independent Button Pressing Surface and Finger Grooves

РУССКИЙ

- 7200 DPI оптический игровой сенсор с настройкой DPI
- Беспроводная технология с частотой опроса 1000 Гц
- Работает как с проводной, так и с беспроводной сетью
- 11-цветная подсветка с 13 режимами
- ЖК-экран с 2 кнопками для настройки DPI, частоты опроса, LOD и настройки угловой привязки
- Литиевая батарея 600 мАч
- Срок службы батареи до 20 часов при частоте опроса 1000 Гц
- Индикатор аккумулятора на ЖК-дисплее
- Переключатели OMRON с 50 миллионами нажатий
- Эргономичная форма с независимой кнопкой нажатия на поверхности и пазами для пальцев

ESPAÑOL

- Sensor Óptico de 7200 DPI con Ajuste de PPP/DPI de Alta Precisión
- Tecnología Inalámbrica de con Ratio de Refresco de 1000Hz
- Funciona tanto Conectado como en Modo Inalámbrico
- Retroiluminación de 11 Colores y 13 Modos
- Pantalla LCD con 2 Botones para configuración de DPI, Ratio de Refresco, Distancia de Alzamiento y Ajuste de Angulos
- Batería de Litio 600mAh
- Batería de hasta 20 Horas, Ratio de Refresco de 1000 Hz
- Indicador de Batería en la Pantalla LCD
- Interruptores OMRON con 50 Millones de Pulsaciones Garantizadas
- Forma Ergonómica con Áreas Independientes de Presión y Ranuras Dactilares

PORTUGUÊS

- Sensor de Jogos Ótico 7200 DPI com sintonia fina DPI
- Tecnologia sem fio com taxa de Polling de 1000Hz
- Opera com fio e sem fio
- Luz de fundo 11 cores com 13 modos
- Tela LCD com 2 botões para DPI, taxa de Polling, LOD e sintonia fina de posicionamento em ângulo
- Bateria de lítio 600mAh
- Vida da bateria até 20 horas na taxa de Polling de 1000Hz
- Indicador de bateria na tela LCD
- Interruptores OMRON com 50 milhões de acionamentos
- Forma ergonômica com superfície de pressão de botões independentes e ranhuras para os dedos

ITALIANO

- Sensore ottico da gioco 7200 DPI con regolazione DPI
- Tecnologia wireless con polling rate di 1000 Hz
- Funziona con rete cablata e wireless
- Illuminazione a 11 colori con 13 modalità
- Schermo LCD con 2 tasti per regolazione di DPI, Polling Rate, LOD e Angle Snapping
- Batteria al litio da 600 mAh
- Autonomia della batteria fino a 20 ore con Polling Rate a 1000 Hz
- Indicatore batteria sullo schermo LCD
- Interruttori OMRON con capacità di 50 milioni di pressioni
- Forma ergonomica con tasto superficie di pressione del tasto indipendente e scanalature per le dita

한국어

- DPI 미세 조정 기능을 가진 7200 DPI 광 게이밍 센서
- 1000Hz 폴링 속도의 무선 기술
- 유선 및 무선 모두 작동
- 13 가지 모드의 11가지 컬러를 가진 Backlight
- DPI, 폴링 속도, LOD, 각도스냅핑(Angle snapping) 등 미세 보정을 위한 2 개의 버튼이 있는 LCD 스크린
- 600mAh 리튬 배터리
- 1000 Hz 폴링 속도에서 배터리 수명 최대 20 시간
- LCD 화면의 배터리 표시 기능
- 5 천만 번 클릭의 옴론 스위치
- 표면 및 Finger Grooves를 독립적인 버튼으로 누를 수 있는 인체 공학적인 디자인

DEUTSCH

- Optischer Gaming-Sensor mit 7200 dpi und dpi-Feineinstellung
- Drahtlostechnologie mit 1000 Hz Abtastrate
- Funktioniert sowohl kabelgebunden als auch kabellos
- 11-farbige Hintergrundbeleuchtung mit 13 Modi
- LCD-Bildschirm mit 2 Tasten zur Feineinstellung von dpi, Abtastrate, LOD und Winkeleinrastung
- 600-mAh-Lithium-Akku
- Akkulaufzeit von bis zu 20 Stunden bei einer Abtastrate von 1000 Hz
- Akkustandanzeige am LCD-Bildschirm
- OMRON-Schalter mit 50 Millionen Anschlägen
- Ergonomische Form mit unabhängiger Tastendruckoberfläche und Fingerkerben

HUNGARIAN

- 7200 DPI optikai játékerzékelő finom DPI hangolással
- Vezeték nélküli technológia 1000 Hz lekérdezési rátával
- Működik vezetékkel és vezeték nélkül
- 11 színű háttérvilágítás 13 móddal
- LCD képernyő 2 gombbal a DPI, lekérdezési ráta, LOD és szögbeállítás finom hangolásához
- 600 mAh lítium akkumulátor
- Akkumulátor élettartam akár 20 óra 1000 Hz lekérdezési rátával
- Akkumulátor kijelző LCD képernyővel
- OMRON kapcsolók 50 millió nyomással
- Ergonomikus forma független gombnyomási felülettel és ujjhelyekkel.

FRANÇAIS

- Capteur de jeu optique 7200 DPI avec réglage fin
- Technologie sans fil avec taux d'interrogation de 1000 Hz
- Fonctionne en mode filaire et sans fil
- Rétroéclairage à 11 couleurs avec 13 modes
- Écran LCD avec 2 boutons pour réglage fin des paramètres DPI, taux d'interrogation, distance de soulèvement (LOD) et correction d'angle
- Batterie lithium 600 mAh
- Autonomie de la batterie pouvant atteindre 20 heures au taux d'interrogation de 1000 Hz
- Indicateur de batterie sur l'écran LCD
- Interrupteurs OMRON avec 50 millions de frappes
- Forme ergonomique avec surface indépendante de pression sur les boutons et rainures pour les doigts

POLISH

- Optyczny sensor gamingowy 7200 DPI z precyzyjną regulacją DPI
- Technologia bezprzewodowa z częstotliwością próbkowania 1000 Hz
- Działa w układzie przewodowym i bezprzewodowym
- 11-kolorowe podświetlenie z 13 trybami
- Ekran LCD z 2 przyciskami do precyzyjnej regulacji DPI, częstotliwości próbkowania, LOD i predykcji
- Bateria litowa 600 mAh
- Żywotność baterii do 20 godzin przy częstotliwości próbkowania 1000 Hz
- Wskaźnik baterii na ekranie LCD
- Przełączniki OMRON na 50 mln nacisków
- Ergonomiczny kształt, niezależna powierzchnia naciskowa i profile na palce

日本語

- 7200 DPIの光学センサーを誇るゲーミングマウスで、DPIを調整可能です
- ボーリングレートは1,000Hzで、ワイヤレステクノロジを採用しています
- ワイヤレスモードと有線モードの両方で動作します
- 11色バックライトカラーと13種類のLEDモードを搭載しています
- 液晶スクリーンを搭載し、DPI、ボーリングレート、LODと直線補正は2つのボタンによって調整可能です
- 600mAhのリチウム電池を装備しています
- 1,000Hzのボーリングレートで最大20時間のバッテリー寿命です
- 液晶スクリーンの画面にバッテリー残量が表示されます
- 5千万回のクリックに耐えるオムロン製スイッチを採用しています
- 人間工学に基づいたボタンデザインを採用しています

中文

- 电竞级7200 DPI光学感应器，可微调DPI数值
- 1000Hz无线传输技术
- 支持有线与无线双模功能
- 内建11种背光颜色与13种背光模式
- 可透过LCD屏幕与按钮，立即调整DPI、回报率、工作高度、与直线修正等功能
- 配有600mAh锂电池
- 1000 Hz回报率下的电池寿命长达20小时
- LCD屏幕显示电池电量
- 保证5千万点击次数的 Omron 欧姆龙按键
- 符合人体工学的按键设计

DEFAULT BUTTON ASSIGNMENT

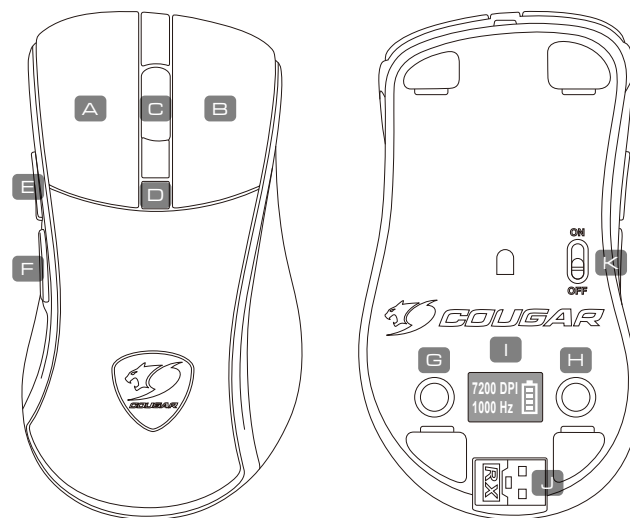

- A Left Click (OMRON 50 million)
- B Right Click (OMRON 50 million)
- C Wheel Click (ALPS Encoder)
- D Color Backlight Cycle
- E Forward
- F Backward
- G Left Button
- H Right Button
- I LCD Screen
- J Dongle
- K Wireless Power switch

SPECIFICATIONS

Product name	SURPASSION RX Gaming Mouse	Maximum tracking speed	150 IPS
Sensor	PixArt PMW3330 Optical gaming sensor	Maximum acceleration	30 G
Resolution	50-7200 DPI	Lithium battery	560mAh
Polling rate	125 / 250 / 500 / 1000Hz	Cable length	1.8m
Switching	50M OMRON gaming switches	Dimension	120(L) X 65(W) X 38(H) mm
Profile LED backlight	2 zone backlight	Weight	98g

The above specifications may vary by country or region

INSTALLATION WIRELESS MODE

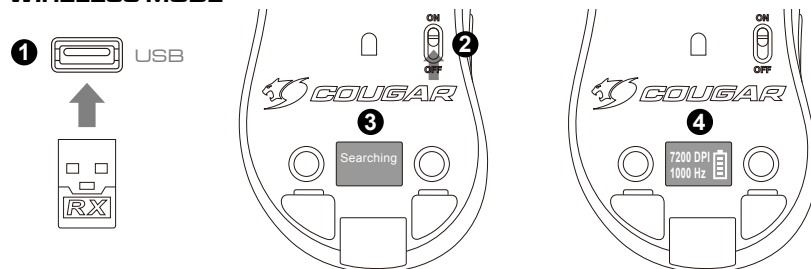

WIRE MODE

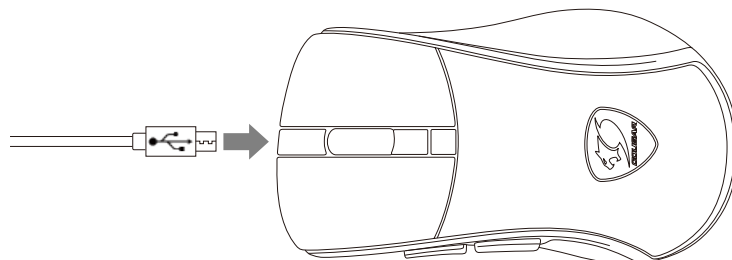

ON-BOARD KEY SETTING CONTROL

<p>Click</p> <p>L R</p>	<p>DPI MODE SWITCH</p> <p>Press the left button to switch between the six DPI modes. The default DPI values for each of the six modes are 400/800/1600/3200/5600/7200 DPI</p>
<p>1 3 Sec</p> <p>L R</p> <p>2</p> <p>3 Click</p>	<p>CUSTOMIZED DPI MODE</p> <p>Press and hold the left button for three seconds; when the DPI number on the LCD screen starts to blink, use the forward/backward buttons to increase or decrease the DPI level in 50 DPI intervals. When you've reached the desired DPI level, press the Left button again to start using this mode.</p>
<p>3 Sec</p> <p>R R R</p>	<p>POLLING RATE / LOD / AS SETTINGS MODE SWITCH</p> <p>Press and hold the right button three seconds to switch between these three customization modes. The active setting will be show on the lower part of the LCD screen.</p> <p>(LOD: Lift off distance, AS: Angle snapping)</p>
<p>Click</p> <p>L R</p>	<p>POLLING RATE SETTINGS (125/250/500/1000Hz)</p> <p>Press the right button to switch between the four polling rate levels.</p>
<p>Click</p> <p>L R</p>	<p>LIFT OFF DISTANCE SETTINGS (LOD: LOW/HIGH)</p> <p>Press the right button to switch between L (Low distance) and H (High distance).</p>
<p>Click</p> <p>L R</p>	<p>ANGLE SNAPPING SETTINGS (AS: ON/OFF)</p> <p>Press the right button to activate or deactivate Angle Snapping.</p>

RESTORE THE DEFAULT SETTING

To restore the default settings, please press and hold the forward, backward and wheel buttons and, without releasing them, connect the mouse to the computer.

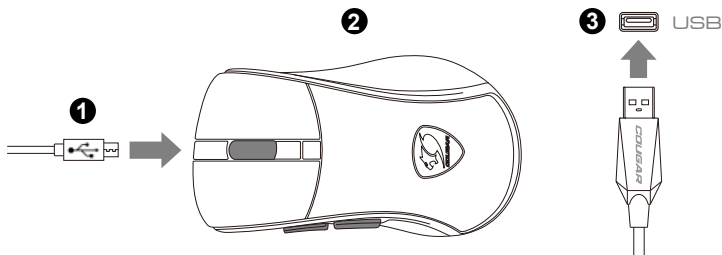

GLOBAL WARRANTY POLICY

WARRANTY PERIODS OF COUGAR GAMING DEVICES

Product : COUGAR SURPASSION RX gaming mouse
Warranty : 1 Year

This warranty gives you specific legal rights. You may also have other rights granted under local law. These rights may vary.

WARRANTY AGREEMENT

- If the product has defects in material or manufacture, COUGAR will provide product repair and replacement service within the warranty period.
- Our warranty service is based on the date of the invoice or warranty card (must be affixed with the store stamp).
- If you lose the aforementioned evidence, we will apply the original shipping date of the product as the beginning date of warranty period. The shipping date will be identified by the product serial number(S/N).

CONDITIONS WHERE FREE MAINTENANCE IS NOT PROVIDED

- Any fault or damage caused by natural disasters (including storm, fire, flood, thunder, earthquake, etc).
- Any fault or damage caused by accidental factors and man-made reasons (including hit, scrape, crash, moving, compression, stain, corrosion, use of incurred on unsuitable voltage, computer virus, riot, misuse, malicious damage, etc).
- Use in an improper operating environment (including high temperature, high humidity, water inflow, etc).
- Inability to provide the product warranty card, purchase receipt or invoice to prove the product is still within the warranty period and the shipping date of the product is out of warranty.
- The warranty card or product serial number has been altered or its number is hard to identify.
- The warranty period has expired.
- Any fault or damage caused by non-compliance with regulations stated on the user manual or improper, rough and careless treatment.
- Any fault or damage caused by use of parts not certified by COUGAR original manufacturer.
- The problem is caused by improper repair or adjustment by the buyer or any manufacturer without authorization from COUGAR.
- The product is not acquired from an authorized distributor of the company or is acquired from illicit sources.
- Paper carton, instruction and other accessories are not warranted.

DISCLAIMERS

- COUGAR does not authorize or endorse the user of COUGAR products as a part of, together with, or connected to, life support devices, medical equipment in general, military equipment, traffic or transportation-related equipment or disaster prevention systems.
- COUGAR is not liable for any damage, expense, loss, cost, injury or any other result derived from the use of COUGAR products not specifically for PC gaming in the compatible operative systems indicated by COUGAR.
- COUGAR is not liable for any damage, expense, loss, cost, injury or any other result due to use of COUGAR products not in strict accordance with the instructions provided by COUGAR in the instruction manual.
- Software, instruction manuals, consumables (for example mouse pads, mouse feet, etc.), boxes or other external packaging are not covered by the warranty.
- For inquiries about the warranty, please contact us at service@cougargaming.com

IN WIRELESS MODE, WHEN THERE IS ONLY ONE BATTERY INDICATOR LEFT, THE LOGO'S LIGHTING GOES OFF, AND THE WHEEL STARTS FLASHING IN RED.

Please use the mouse in wired mode to recharge its battery.

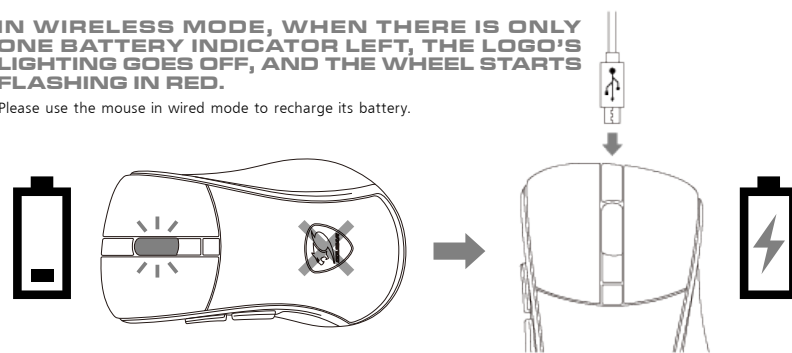

WHEN THE MOUSE HAS NOT BEEN USED FOR EIGHT CONSECUTIVE MINUTES, THE MOUSE GOES INTO SLEEP MODE

Please press any button to reactivate the mouse.

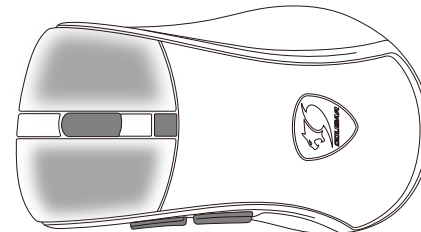

IF THE DONGLE AND THE MOUSE CAN'T PAIR

Connect the dongle to your computer's USB port and, within 15 seconds of connecting it, press the right mouse button and the wheel button simultaneously to pair mouse and dongle.

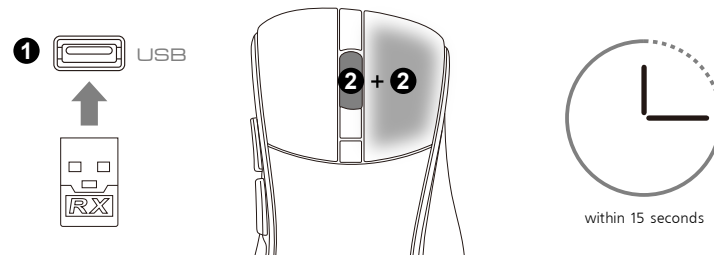

PACKAGE CONTAINS

COUGAR SURPASSION RX Gaming Mouse
Dongle / Cable / User Manual

To achieve optimal performance, it is highly recommended that you use this product with COUGAR Mouse Pads.

LEGAL NOTICES

This manual was created by Compucase Enterprise and may not be completely or partially copied, passed on, distributed or stored without written consent by Compucase Enterprise. COUGAR® is a registered brand of Compucase Enterprise Other product and company names mentioned in this documentation may be brands or trademarks of their respective owners. Compucase Enterprise reserves the right to make changes concerning the contents of the manual and the technical data of the product without previous announcement.

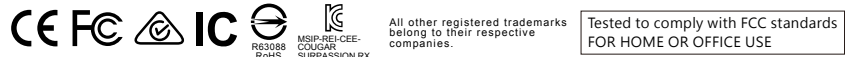

MANUFACTURER CONTACT

Compucase Enterprise Co.,Ltd.
No. 225, Lane 54, An Ho Road Sec. 2 Tainan, Taiwan, R.O.C
Tel:+886-6-356-0606
Service E-Mail: service@cougargaming.com

COUGAR USA Technical Service
Tel: (833) 256-3778
Mail: rma@compucaseusa.com
https://cougargaming.com/support/contact/upload/

CAUTION

Please do not directly look into the optical beam!

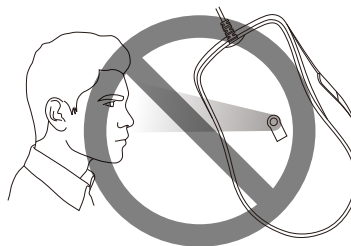

تعليمات التركيب و الأمان:
- امسك الماوس بالشكل السليم مع عدم رفع الذراع.
- لا تنتظر للإشعاع المنبعث من الأشعة بشكل مباشر.
- التزم بالوضعية الصحيحة و المريحة عند إلامسك بالماوس.
- يجب التأكد من توصيل كافة التوصيلات بالشكل الصحيح.
- احفظ الجهاز بعيداً عن مصادر المياه و الرطوبة.
- الفصل التيار الكهربائي فوراً في حالة الإشتباه بوجود التماس.
- تأكد بأن مصدر الطاقة لديك مناسب لما يحتاجه هذا الجهاز.

ДАТА ИЗГОТОВЛЕНИЯ ПРОДУКЦИИ

год и месяц изготовления продукции указаны в серийном номере продукта. (существует 2 способа определения даты изготовления, оба способа описаны ниже)

- A** После S/N: первые две цифры означают год, вторые две – месяц изготовления.
Например, S/N: H1702000001 означает, что товар был произведен в феврале 2017 года.
- B** После S/N: если указаны буквы, то две буквы представляют цифры из таблицы ниже, и означают год, последующие две цифры – месяц изготовления.
Например, S/N: DAG02REV1000001 означает, что товар был произведен в феврале 2017 года.

A	B	C	D	E	F	G	H	I	J
1	2	3	4	5	6	7	8	9	0

• Например, AG = 17 = 2017 год